

M2 FLIGHT CONTROLLER SETTINGS

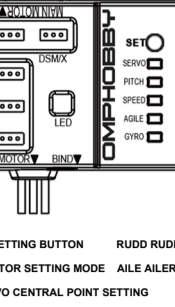

WWW.OMPHOBBY.COM

DIAGRAM OF FLIGHT CONTROLLER

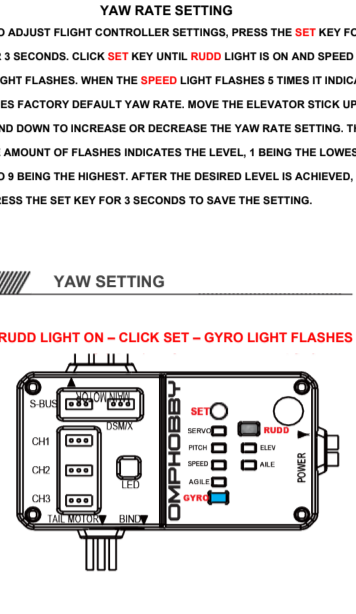

SET MENU SETTING BUTTON RUDD RUDDER SETTING MODE
 ELEV ELEVATOR SETTING MODE AILE AILERON SETTING MODE
 SERVO SERVO CENTRAL POINT SETTING
 PITCH PITCH SETTING SPEED SPEED RATE INDICATOR
 AGILE AGILITY INDICATOR GYRO GYRO GAIN INDICATOR

NOTE: BIND TRANSMITTER TO FLIGHT CONTROLLER, WAIT FOR THE INITIALIZATION, THEN START SETTINGS.

-1-

YAW SETTING

PRESS SET FOR 3 SECONDS – RUDD LIGHT ON – SPEED LIGHT FLASHES

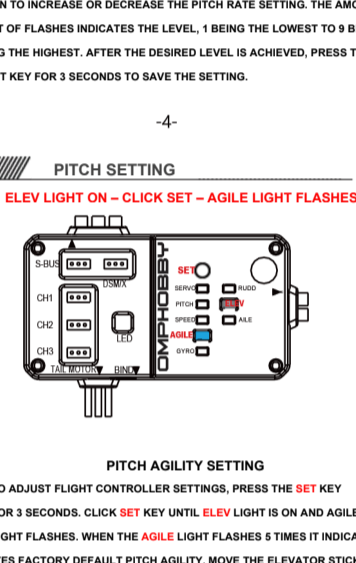

YAW RATE SETTING

TO ADJUST FLIGHT CONTROLLER SETTINGS, PRESS THE SET KEY FOR 3 SECONDS. CLICK SET KEY UNTIL RUDD LIGHT IS ON AND SPEED LIGHT FLASHES. WHEN THE SPEED LIGHT FLASHES 5 TIMES IT INDICATES FACTORY DEFAULT YAW RATE. MOVE THE ELEVATOR STICK UP AND DOWN TO INCREASE OR DECREASE THE YAW RATE SETTING. THE AMOUNT OF FLASHES INDICATES THE LEVEL, 1 BEING THE LOWEST TO 9 BEING THE HIGHEST. AFTER THE DESIRED LEVEL IS ACHIEVED, PRESS THE SET KEY FOR 3 SECONDS TO SAVE THE SETTING.

YAW SETTING

RUDD LIGHT ON – CLICK SET – GYRO LIGHT FLASHES

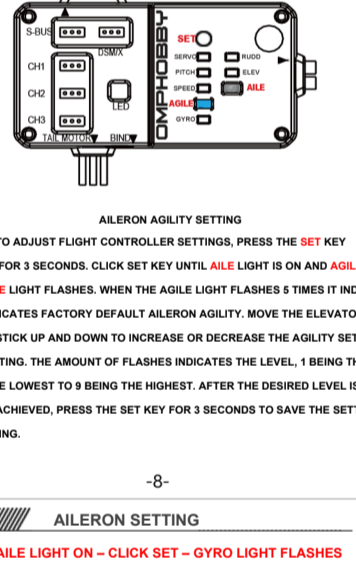

YAW GAIN SETTING

TO ADJUST FLIGHT CONTROLLER SETTINGS, PRESS THE SET KEY FOR 3 SECONDS. CLICK SET KEY UNTIL RUDD LIGHT IS ON AND GYRO LIGHT FLASHES. WHEN THE GYRO LIGHT FLASHES 5 TIMES IT INDICATES FACTORY DEFAULT YAW GAIN. MOVE THE ELEVATOR STICK UP AND DOWN TO INCREASE OR DECREASE THE YAW GAIN SETTING. THE AMOUNT OF FLASHES INDICATES THE LEVEL, 1 BEING THE LOWEST TO 9 BEING THE HIGHEST. AFTER THE DESIRED LEVEL IS ACHIEVED, PRESS THE SET KEY FOR 3 SECONDS TO SAVE THE SETTING.

-3-

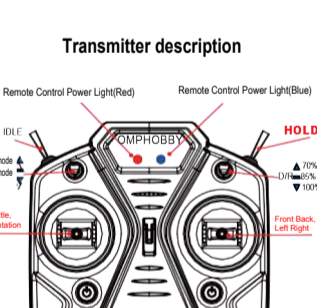

www.omphobby.com

PITCH SETTING

PRESS SET 3 SECONDS – ELEV LIGHT ON – SPEED LIGHT FLASHES

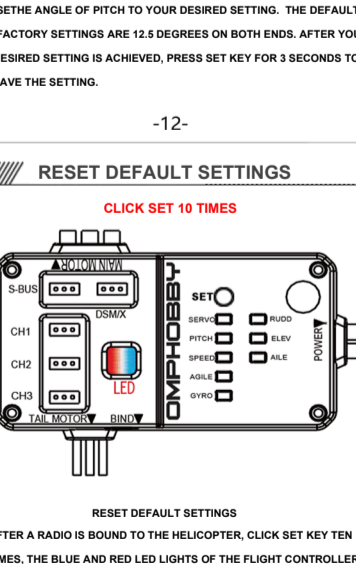

PITCH RATE SETTING

TO ADJUST FLIGHT CONTROLLER SETTINGS, PRESS THE SET KEY FOR 3 SECONDS. CLICK SET KEY UNTIL ELEV LIGHT IS ON AND SPEED LIGHT FLASHES. WHEN THE SPEED LIGHT FLASHES 5 TIMES IT INDICATES FACTORY DEFAULT PITCH RATE. MOVE THE ELEVATOR STICK UP AND DOWN TO INCREASE OR DECREASE THE PITCH RATE SETTING. THE AMOUNT OF FLASHES INDICATES THE LEVEL, 1 BEING THE LOWEST TO 9 BEING THE HIGHEST. AFTER THE DESIRED LEVEL IS ACHIEVED, PRESS THE SET KEY FOR 3 SECONDS TO SAVE THE SETTING.

-4-

PITCH SETTING

ELEV LIGHT ON – CLICK SET – AGILE LIGHT FLASHES

PITCH AGILITY SETTING

TO ADJUST FLIGHT CONTROLLER SETTINGS, PRESS THE SET KEY FOR 3 SECONDS. CLICK SET KEY UNTIL ELEV LIGHT IS ON AND AGILE LIGHT FLASHES. WHEN THE AGILE LIGHT FLASHES 5 TIMES IT INDICATES FACTORY DEFAULT PITCH AGILITY. MOVE THE ELEVATOR STICK UP AND DOWN TO INCREASE OR DECREASE THE AGILITY SETTING. THE AMOUNT OF FLASHES INDICATES THE LEVEL, 1 BEING THE LOWEST TO 9 BEING THE HIGHEST. AFTER THE DESIRED LEVEL IS ACHIEVED, PRESS THE SET KEY FOR 3 SECONDS TO SAVE THE SETTING.

-5-

PITCH SETTING

ELEV LIGHT ON – CLICK SET – GYRO LIGHT FLASHES

TO ADJUST FLIGHT CONTROLLER SETTINGS, PRESS THE SET KEY FOR 3 SECONDS. CLICK SET KEY UNTIL ELEV LIGHT IS ON AND GYRO LIGHT FLASHES. WHEN THE GYRO LIGHT FLASHES 5 TIMES IT INDICATES FACTORY DEFAULT PITCH GAIN. MOVE THE ELEVATOR STICK UP AND DOWN TO INCREASE OR DECREASE THE GAIN SETTING. THE AMOUNT OF FLASHES INDICATES THE LEVEL, 1 BEING THE LOWEST TO 9 BEING THE HIGHEST. AFTER THE DESIRED LEVEL IS ACHIEVED, PRESS THE SET KEY FOR 3 SECONDS TO SAVE THE SETTING.

-6-

AILERON SETTING

PRESS SET 3 SECONDS – AILE LIGHT ON – SPEED LIGHT FLASHES

AILERON RATE SETTING

TO ADJUST FLIGHT CONTROLLER SETTINGS, PRESS THE SET KEY FOR 3 SECONDS. CLICK SET KEY UNTIL AILE LIGHT IS ON AND SPEED LIGHT FLASHES. WHEN THE SPEED LIGHT FLASHES 5 TIMES IT INDICATES FACTORY DEFAULT AILERON RATE. MOVE THE ELEVATOR STICK UP AND DOWN TO INCREASE OR DECREASE THE RATE SETTING. THE AMOUNT OF FLASHES INDICATES THE LEVEL, 1 BEING THE LOWEST TO 9 BEING THE HIGHEST. AFTER THE DESIRED LEVEL IS ACHIEVED, PRESS THE SET KEY FOR 3 SECONDS TO SAVE THE SETTING.

-7-

AILERON SETTING

AILE LIGHT ON – CLICK SET – AGILE LIGHT FLASHES

AILERON AGILITY SETTING

TO ADJUST FLIGHT CONTROLLER SETTINGS, PRESS THE SET KEY FOR 3 SECONDS. CLICK SET KEY UNTIL AILE LIGHT IS ON AND AGILE LIGHT FLASHES. WHEN THE AGILE LIGHT FLASHES 5 TIMES IT INDICATES FACTORY DEFAULT AILERON AGILITY. MOVE THE ELEVATOR STICK UP AND DOWN TO INCREASE OR DECREASE THE AGILITY SETTING. THE AMOUNT OF FLASHES INDICATES THE LEVEL, 1 BEING THE LOWEST TO 9 BEING THE HIGHEST. AFTER THE DESIRED LEVEL IS ACHIEVED, PRESS THE SET KEY FOR 3 SECONDS TO SAVE THE SETTING.

-8-

AILERON SETTING

AILE LIGHT ON – CLICK SET – GYRO LIGHT FLASHES

AILERON GAIN SETTING

TO ADJUST FLIGHT CONTROLLER SETTINGS, PRESS THE SET KEY FOR 3 SECONDS. CLICK SET KEY UNTIL AILE LIGHT IS ON AND GYRO LIGHT FLASHES. WHEN THE GYRO LIGHT FLASHES 5 TIMES IT INDICATES FACTORY DEFAULT AILERON GAIN. MOVE THE ELEVATOR STICK UP AND DOWN TO INCREASE OR DECREASE THE GAIN SETTING. THE AMOUNT OF FLASHES INDICATES THE LEVEL, 1 BEING THE LOWEST TO 9 BEING THE HIGHEST. AFTER THE DESIRED LEVEL IS ACHIEVED, PRESS THE SET KEY FOR 3 SECONDS TO SAVE THE SETTING.

-9-

SERVO MID-POINT SETTING

SERVO MID-POINT SETTING

SERVO MID-POINT SETTING

TO ADJUST FLIGHT CONTROLLER SETTINGS, PRESS THE SET KEY FOR 3 SECONDS. CLICK SET KEY UNTIL SERVO LIGHT IS ON. USE THE STICKS OF AILERON, ELEVATOR, AND RUDDER TO SETUP THE MID-POINT OF THE SERVOS. CH1 IS FOR AILERON, CH2 FOR ELEVATOR, AND CH3 FOR RUDDER. AFTER DESIRED MID-POINT IS ACHIEVED, PRESS SET KEY FOR 3 SECONDS TO SAVE THE SETTING.

-10-

COLLECTIVE PITCH SETTING

Transmitter description

-11-

COLLECTIVE PITCH SETTING

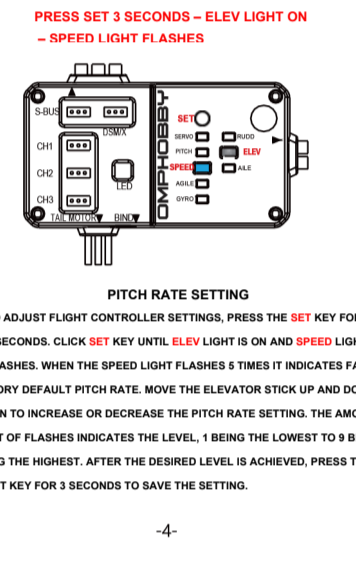

CLICK SET – PITCH LIGHT ON

COLLECTIVE PITCH SETTING

TO ADJUST FLIGHT CONTROLLER SETTINGS, PRESS THE SET KEY FOR 3 SECONDS. CLICK SET KEY UNTIL PITCH LIGHT IS ON. TOGGLE THE HOLD SWITCH OF RADIO TRANSMITTER TO ACTIVATE THE THROTTLE-CUT. BEGIN BY MOVING THE THROTTLE STICK TO 50% MID-POINT AND USING A PITCH GAUGE ENSURE A READING OF ZERO. THEN MOVE THE THROTTLE STICK TO THE HIGHEST POSITION, USE THE ELEVATOR STICK TO INCREASE OR DECREASE THE ANGLE OF PITCH TO YOUR DESIRED SETTING. MOVE THE THROTTLE STICK TO THE LOWEST POSITION, USE THE ELEVATOR STICK TO INCREASE OR DECREASE THE ANGLE OF PITCH TO YOUR DESIRED SETTING. THE DEFAULT FACTORY SETTINGS ARE 12.5 DEGREES ON BOTH ENDS. AFTER YOUR DESIRED SETTING IS ACHIEVED, PRESS SET KEY FOR 3 SECONDS TO SAVE THE SETTING.

-12-

RESET DEFAULT SETTINGS

CLICK SET 10 TIMES

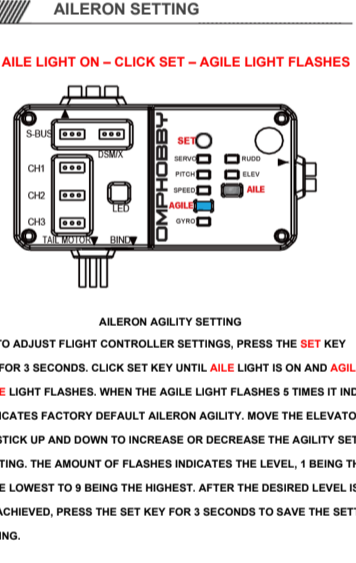

RESET DEFAULT SETTINGS

AFTER A RADIO IS BOUND TO THE HELICOPTER, CLICK SET KEY TEN TIMES, THE BLUE AND RED LED LIGHTS OF THE FLIGHT CONTROLLER WILL FLASH AT THE SAME TIME. RESET IS DONE AFTER THE INITIALIZATION OF FLIGHT CONTROL.

-13-

DIAGRAM OF FLIGHT CONTROL SETTINGS

White light on	Blue light flashes. 5 continuous flashes indicate factory default setting	Push elevator stick once to add a value, and pull elevator stick once to decrease a value. A set of continuous flashes indicates the value of a level. Values range from 1 to 9.
RUDD Rudder	SPEED	
ELEV Elevator	AGILE	
AILE Aileron	GYRO	
	SPEED	
	AGILE	
	GYRO	

藍灯常亮	
Servo central point setting	CH1 for aileron CH2 for elevator CH3 for rudder

-14-

DIAGRAM OF FLIGHT CONTROL SETTINGS

PITCH Pitch setting	Use elevator stick to set value
---------------------	---------------------------------

-15-